

Type 1
Aire Hydraulique 6,75m²
Rayon Hydraulique 0,647m

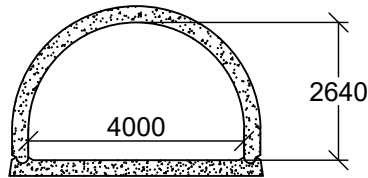

Type 2
Aire Hydraulique 8,75m²
Rayon Hydraulique 0,766m

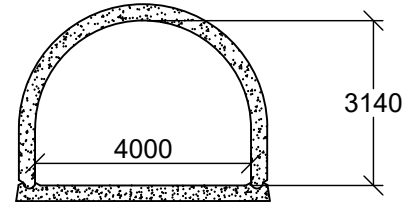

Type 3
Aire Hydraulique 10,75m²
Rayon Hydraulique 0,866m

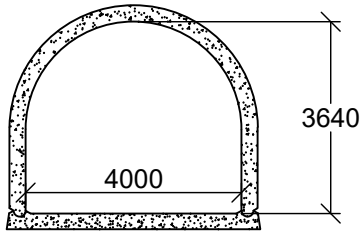

Type 4
Aire Hydraulique 12,75m²
Rayon Hydraulique 0,950m

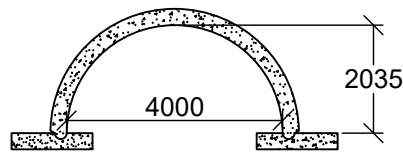

Type 5
Aire Hydraulique 6,40m²
Rayon Hydraulique 0,619m

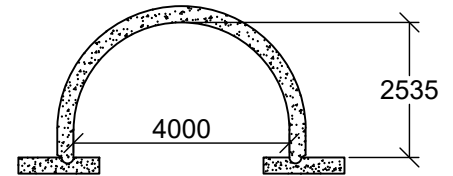

Type 6
Aire Hydraulique 8,40m²
Rayon Hydraulique 0,741m

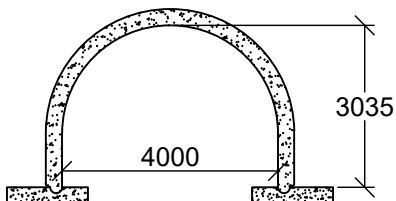

Type 7
Aire Hydraulique 10,40m²
Rayon Hydraulique 0,843m

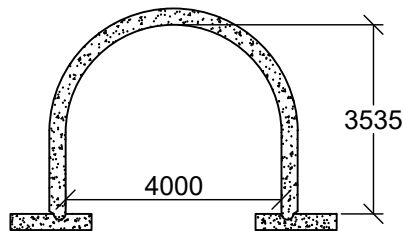

Type 8
Aire Hydraulique 12,40m²
Rayon Hydraulique 0,929m

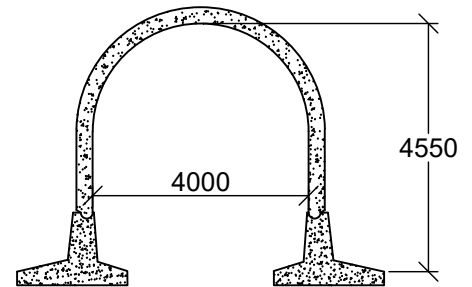

Type 9
Aire Hydraulique 16,20m²
Rayon Hydraulique 1,076m

Selon CSA A23.4